

BL006200



Engineering
GREAT Solutions

Control valves for general applications

BL006200

Concept of Balance Valves

Balance valves are mainly for flow balance control at the terminals and loops of commercial and industrial HVAC systems to tackle hydraulic imbalance. The cooling and heating changes of air-conditioning systems and their operation effect are closely related to the proper application of balance valves. NEPTUNE's balance technology enables hydraulic balance fully, thus cutting energy consumption, and enhancing heating comfort of air-conditioning systems. Building on this technology, NEPTUNE has provided proper product models and technical services for several products, gathering rich project exp

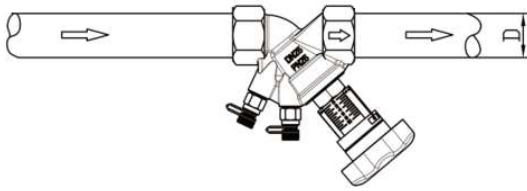

In HVAC systems with hydraulic balance, it is very critical to use meters featuring stable and precise performance. These meters can transmit data of differential pressure, flow and temperature to the computer for accurate regulating

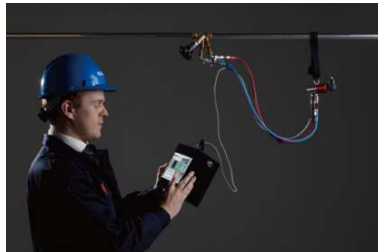

How To Measure?

1. Fill the sensor with fluid to ensure correct measurement.
2. Ensure the measuring probe is free from blockage.
3. Insert the measuring probe into the measuring point of the balance valve vertically as the probe is subject to bending and breakage.
4. Maximum differential pressure between the first and second measurements by the pressure differential sensor: 12 Bar.
5. Blow gas into the sensor to drain fluid fully and prevent damage due to freezing.
6. Prevent device from falling down, squeezed and under water.

The valves designed and manufactured by Neptune provide ideal and correct solutions in the recommended application fields at the lowest purchasing and maintenance cost, able to meet and exceed the specified standards developed through years of experience, researches and laboratory testing.

Applications

- > Construction field: In the water supply pipeline of buildings, balance valves can be used to adjust the water pressure difference between different floors to ensure stable water pressure on each floor.
- > Heating field: In the heating system, balance valves can be used to adjust the heating amount between different rooms, thereby achieving balanced distribution of heat.
- > In the field of air conditioning: In air conditioning systems, balance valves can be used to regulate the flow of coolant, thereby achieving temperature balance control..

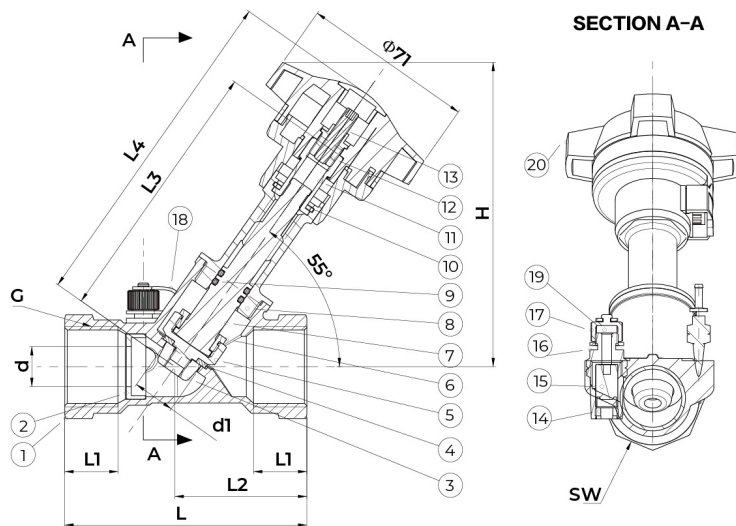
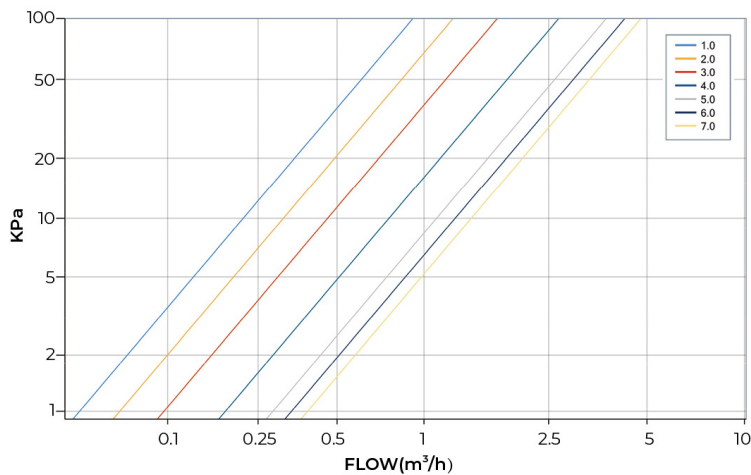

Unit: mm

DN	G	Kvs(m³/h)	L	L1	L2	L3	L4	H	d	d1	SW
15	G1/2"	0.4-1.5	87.5	18.5	43	81	109	102	Φ8.5	Φ10	27
20	G3/4"	0.4-2.1	96	20	49	85	113	105	Φ12.5	Φ13.5	31.5
25	G1"	1-4.4	100	22	55	110	138	113	Φ16.5	Φ17.5	40
32	G1-1/4"	2.4-9.9	114	26	62.5	113.5	141.5	128.5	Φ23	Φ24.5	50
40	G1-1/2"	3.2-13.8	125	26	71	130	158	142	Φ28.5	Φ32	55.5
50	G2"	4.4-24.6	146	29.5	83.5	130	158	142	Φ38.5	Φ39	68.5

20	HANDLEWHEEL	1	ABS
19	SEAL GASKET	2	EPDM
18	HANG BUCKLE	2	PLASTIC
17	TEST COCK CAP	2	CW617N
16	TEST COCK BODY	2	CW617N
15	RUBBER PLUG	2	EPDM
14	BRASS RING	2	CW617N
13	SET SCREW	1	SS304
12	FLANGE NUT	1	CW617N
11	STEM SET	1	CW617N
10	CIRCLIP	1	SS304
9	O-RING	2	EPDM
8	BONNET	1	CW617N
7	STEM	1	CW617N
6	STEM NUT	1	CW617N For 1"-2"only
5	DISC	1	CW617N 1/2"-3/4" don't have this part
4	LOWER SEAL GASKET	1	PTFE
3	LOWER STEM NUT	1	CW617N
2	BRASS RING	1	CW617N
1	BODY	1	C83600

No.	Part	QTY	MATERIAL
-----	------	-----	----------



NEPTUNE USA
200continental,
drive suite 401,
NEWARK DE
19713
PR Delaware

Tel: +1/302.313.7583

NEPTUNE ASIA
No. 78, Lane 4855,
Guangfulin Road,
Songjiang, Shanghai
201600
PR China

Tel: +86 021-31006711

* For any data errors or questions, please contact the manufacturer.

* Neptune reserves the right to change drawings, content, modifying or data updating herein without further notice.